

© This drawing remains the property of Pinpoint Engineer Ltd and shall not be copied without prior written consent.
 All dimensions to be checked on site and any discrepancies to be reported before work commences.
 Tree information including species, heights, diameters and spread are an approximation only and is subject to discrepancy, should propagate and detailed information be required a specialist should be sought.
 If scaling off this drawing the scale should be utilised to verify paper size is correct.

CONTROL STATIONS				
REFERENCE	POINT STYLE	EASTING	NORTHING	HEIGHT
STN1	HILTI NAIL	960.586	423.860	38.122
STN2	HILTI NAIL	980.551	462.937	38.100
STN3	HILTI NAIL	980.692	440.478	38.101
STN4	HILTI NAIL	999.793	430.931	38.317

TREE SCHEDULE			
TREE	TRUNK DIAMETER	SPREAD	HEIGHT
T1	0.200	6.000	5.000
T2	2.000	14.000	22.000
T3	0.750	10.000	16.000
T4	0.750	10.000	20.000
T5	0.450	4.500	12.000
T6	0.250	4.000	11.000
T7	0.300	5.000	11.000 </tr

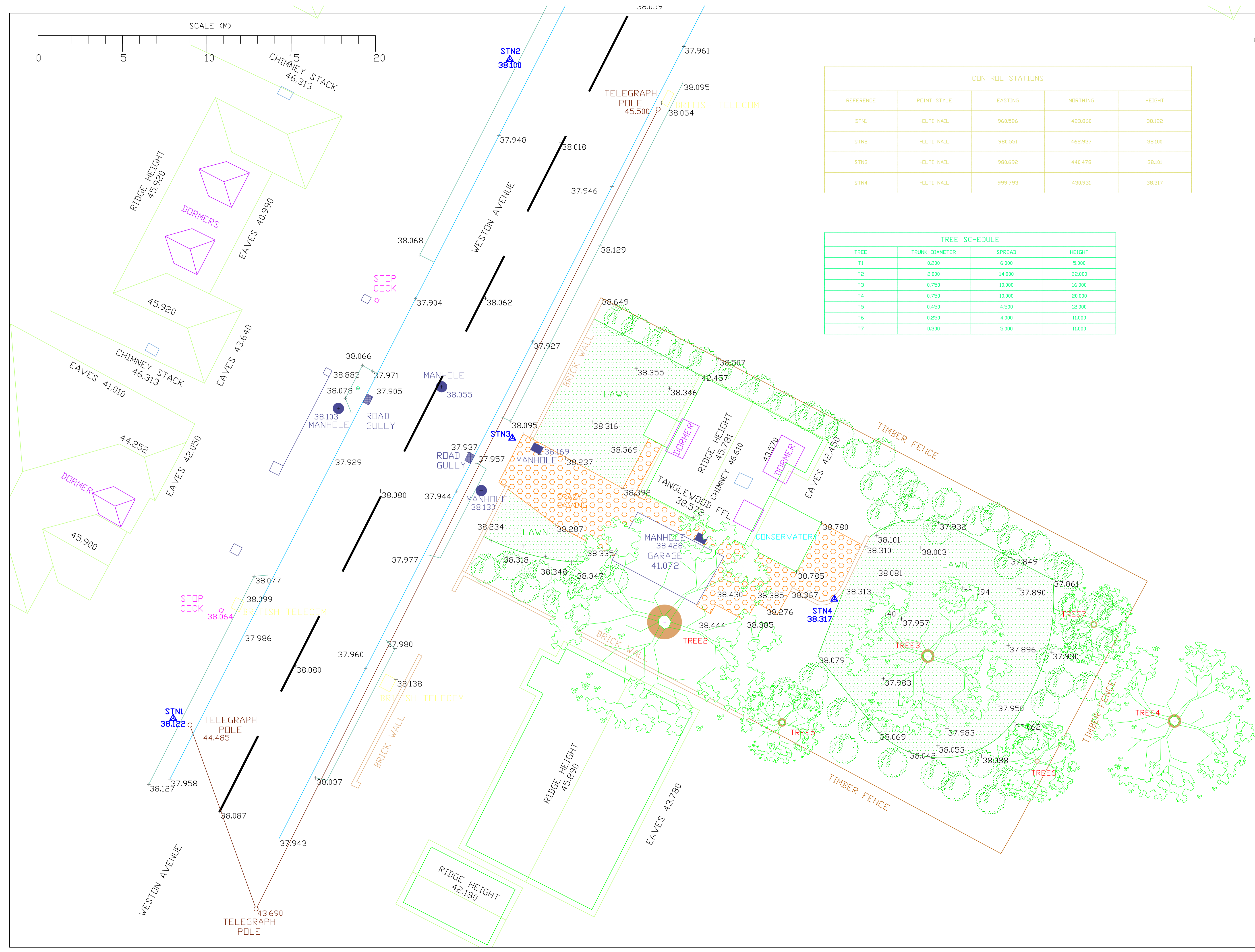

Rev	Comment	By	Date

PINPOINT ENGINEER

TEL: 07815958772
 E-MAIL: RDM@PINPOINTENGINEER.CO.UK
 WEB: PINPOINTENGINEER.CO.UK
 ADDRESS: 37, CHESTERTON DRIVE, MERSTHAM, SURREY, RH1 3NZ

Client:		
FORBES CLAYMORE		
Job Title:		
7 WESTON AVENUE THAMES DITTON		
Drawing Title:		
TOPOGRAPHICAL SURVEY		
Status:		
INFORMATION		
Date Drawn:	Drawn By:	Scale:
01/05/2016	R.MILNE	A1 1:100
Job Reference:	Dwg No:	Rev:
-	FC-001	-