

© This drawing remains the property of Pinpoint Engineer Ltd and shall not be copied without prior written consent.
 All dimensions to be checked on site and any discrepancies to be reported before work commences.
 Tree information including species, heights, diameters and spread are an approximation only and is subject to discrepancy, should accurate and detailed information be required a specialist should be sought.
 If scaling off this drawing the scale bar should be utilised to verify paper size is correct.

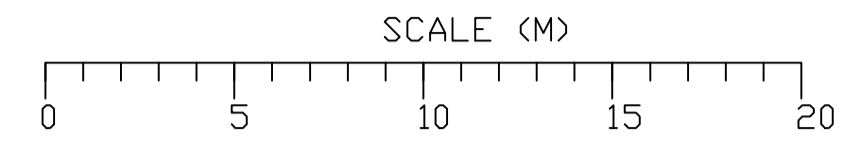

TREE	TRUNK DIAMETER	SPREAD	HEIGHT	SPECIES
T1	0.700	9.000	17.000	DAK
T2	0.550	10.000	11.000	DAK
T3	0.450	7.000	11.000	DAK
T4	0.450	7.000	11.000	DAK
T5	0.800	10.000	11.000	DAK
T6	0.400	6.000	14.000	DAK
T7	0.200	2.000	9.000	CDNIFER
T8	0.450	2.000	9.000	CDNIFER
T9	0.250	2.000	9.000	CDNIFER
T10	0.250	2.000	9.000	CDNIFER
T11	0.250	2.000	9.000	CDNIFER
T12	0.250	2.000	9.000	CDNIFER
T13	0.250	2.000	9.000	CDNIFER
T14	0.900	10.000	1.000	DAK
T15	0.500	1.000	16.000	DAK
T16	0.900	7.000	16.000	UNKNOWN
T17	1.200	12.000	16.000	DAK
T19	0.800	14.000	18.000	DAK
T20	7.000	19.000	17.000	DAK
T21	0.550	8.000	12.000	DAK
T22	0.900	16.000	16.000	DAK
T23	0.800	14.000	16.000	DAK
T25	0.200	2.000	8.000	UNKNOWN

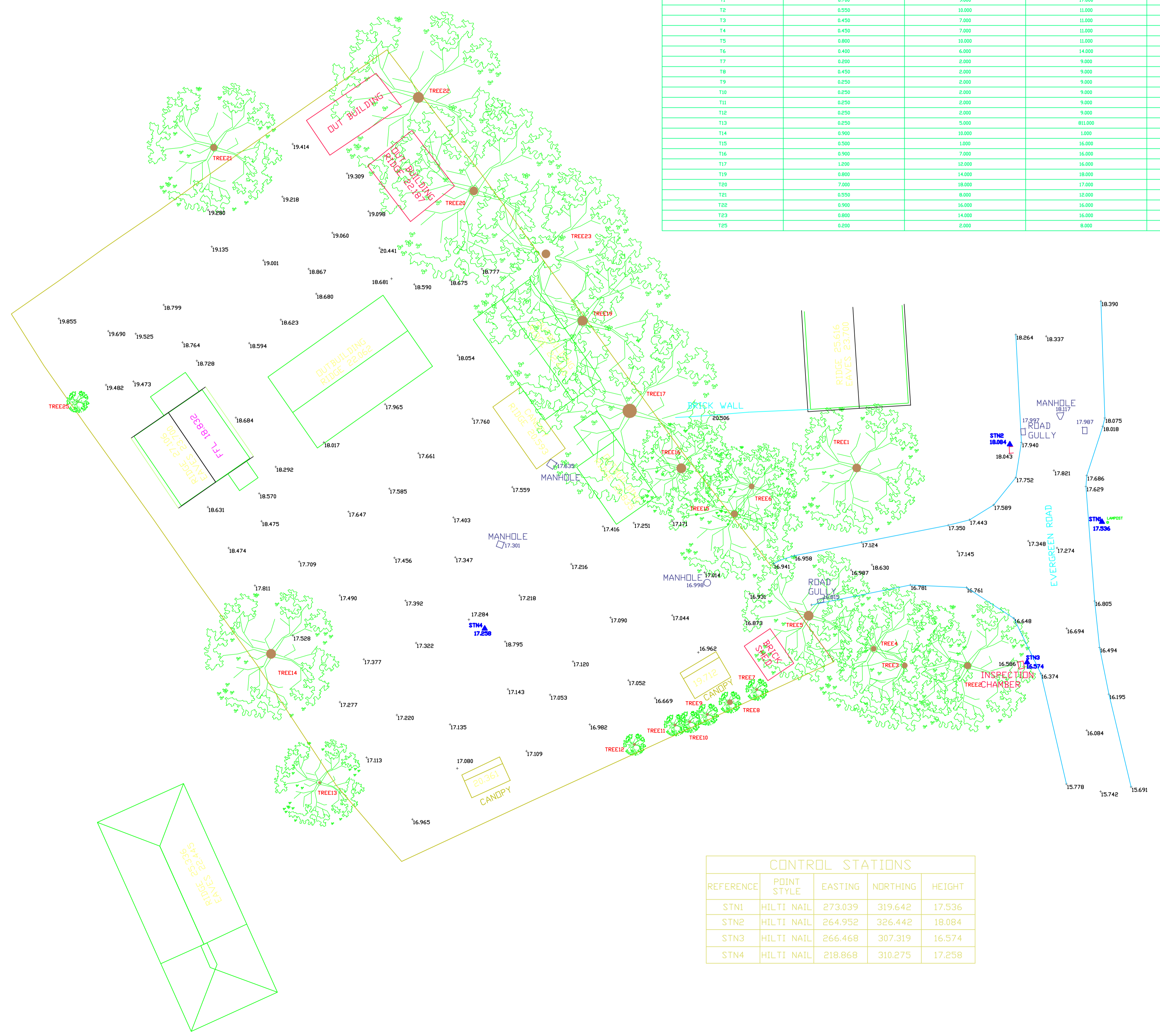

REFERENCE	POINT STYLE	EASTING	NORTHING	HEIGHT
STN1	HILTI NAIL	273.039	319.642	17.536
STN2	HILTI NAIL	264.952	326.442	18.084
STN3	HILTI NAIL	266.468	307.319	16.574
STN4	HILTI NAIL	218.868	310.275	17.258

Rev	Comment	By	Date

PINPOINT ENGINEER

TEL: 07815958772
 E-MAIL: RDM@PINPOINTENGINEER.CO.UK
 WEB: PINPOINTENGINEER.CO.UK
 ADDRESS: 37, CHESTERTON DRIVE, MERSTHAM, SURREY, RH1 3NZ

Client: DAVE KNOTT

Job Title: 70 EVERGREEN ROAD, FRIMLEY

Drawing Title: TOPOGRAPHICAL SURVEY

Status: INFORMATION

Date Drawn: 05/06/2016	Drawn By: R. MILNE	Scale: A1 1:200
Job Reference: -	Drig No: DK-001	Rev: -